

DIN 466

Ghiera cilindrica zigrinata

con colletto alto

Knurled nut

with collar

disponibile AISI 303 / A1

available AISI 303 / A1

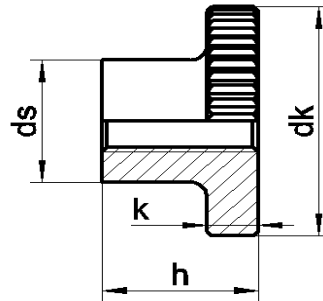
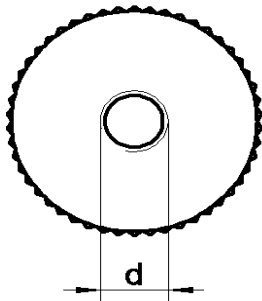

Con foro passante
Through hole

d	dk	ds	h	k
M2,5	11	5	6,5	2,5
M3	12	6	7,5	2,5
M4	16	8	9,5	3,5
M5	20	10	11,5	4
M6	24	12	15	5
M8	30	16	18	6
M10	36	20	23	8